



Nero

RAL 9005

DATI TECNICI

Potenza nominale (max.)	10,3 kW
Rendimento (max.)	85,3 %
Temperatura dei fumi (max.)	241 °C
Lunghezza max ciocchi di legna	500 mm
Consumo orario (max.)	2,75 kg/h
Volume riscaldabile (indicativo)	295 m³
Emissioni CO (13% O ₂) (max.)	1069 mg/m³
Massa fumi (max.)	7 g/s
Peso	125 kg
Dimensioni LxPxH	700x500x1133 mm
Dimensione uscita fumi	ø 150 mm
Uscita fumi	Posteriore, superiore

DOTAZIONI



Regolazione aria primaria, secondaria, terziaria vetro



Contenitore cenere estraibile



Camera combustione rivestita da isolante in vermiculite

DIMENSIONI ED INGOMBRI

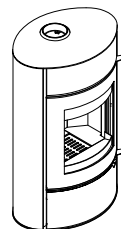
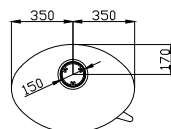
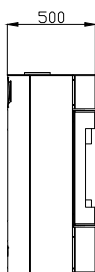
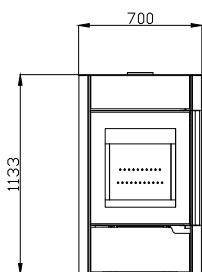
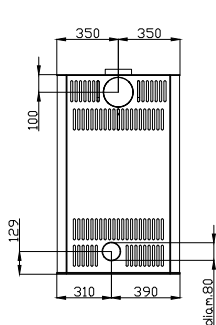

- A Scarico fumi ø 80 mm
- B Aspirazione aria ø 40 mm
- C Interruttore on/off
- D Termostato a riarmo manuale

CERTIFICAZIONI

EN 13240:2006

Swiss TRV Limits

German BIMSChv

Flamme Verte (7 stars)



TECHNICAL DATA

Nominal heat output (max.)	10,3 kW
Efficiency (max.)	85,3 %
Flue gas temperature (max.)	241 °C
Max length of wood logs	500 mm
Hourly consumption (max.)	2,75 kg/h
Heating volume	295 m³
Emissions CO (13% O ₂) (max.)	1069 mg/m³
Flue gas mass flow (max.)	7 g/s
Weight	125 kg
Dimensions LxPxH	700x500x1133 mm
Smoke outlet dimensions	ø 150 mm
Smoke outlet	Rear, upper exhaust



Black RAL 9005

DEVICES



Primary, secondary, tertiary (glass) air flow control



Removable ash container



Combustion chamber with vermiculite insulation

DIMENSIONS

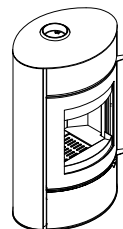
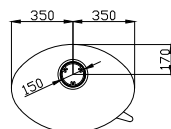
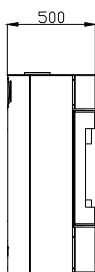
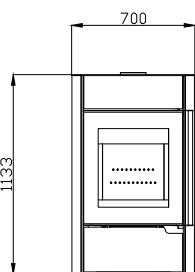
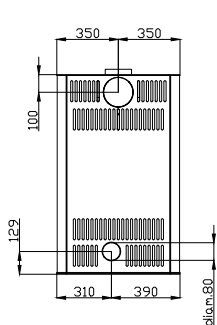

- A Smoke outlet ø 80 mm
- B External air inlet ø 40 mm
- C Electric socket
- D Manual reset thermostat

CERTIFICATIONS

EN 13240:2006

Swiss TRV Limits

German BIMSChv

Flamme Verte (7 stars)



CERTIFICAZIONE AMBIENTALE



DONNÉES TECHNIQUES

Potenza nominale (max.)	10,3 kW
Rendimento (max.)	85,3 %
Température des fumées (max.)	241 °C
Longueur max des bûches de bois	500 mm
Consommation horaire (max.)	2,75 kg/h
Capacité de chauffe	295 m³
Emissions CO (13% O ₂) (max.)	1069 mg/m³
Débit de fumées (max.)	7 g/s
Poids	125 kg
Dimensions LxPxH	700x500x1133 mm
Sortie de fumée	ø 150 mm
Sortie de fumée	Sortie postérieure, supérieure



EQUIPEMENT

- Réglage du débit d'air primaire, secondaire, tertiaire (verre)
- Cendrier amovible
- Chambre de combustion avec isolation en vermiculite

DIMENSIONS

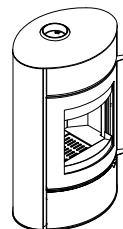
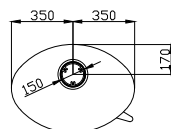
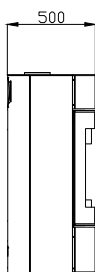
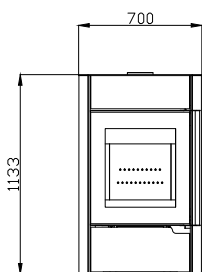
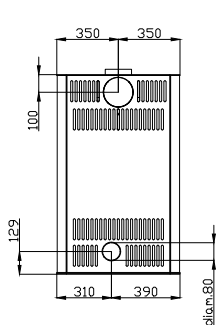

- A** Évacuation fumées ø 80 mm
- B** Prise d'aire comburant ø 40 mm
- C** Interrupteur
- D** Thermostat à réarmement manuel

CERTIFICATIONS

EN 13240:2006

Swiss TRV Limits

German BIMSChv

Flamme Verte (7 stars)



Schwarz RAL 9005

TECHNISCHE DATEN

Nennwärmeleistung (max.)	10,3 kW
Wirkungsgrad (max.)	85,3 %
Abgastemperatur (max.)	241 °C
Max Länge von Holz Protokolle	500 mm
Stundenverbrauch (max.)	2,75 kg/h
Raumheizvermöge	295 m³
Emissionen CO (13% O ₂) (max.)	1069 mg/m³
Abgasmassenstrom (max.)	7 g/s
Gewicht	125 kg
Bemaßung LxPxH	700x500x1133 mm
Rauchabzug	ø 150 mm
Rauchabzug	Abgasstutzen Hinten, Oben

AUSRÜSTUNG



Primäre, sekundäre, tertiäre (Glas) Luftstromregelung



Herausnehmbare Aschenlade



Brennkammer mit Isolierung aus Vermiculit

GRÖSSE

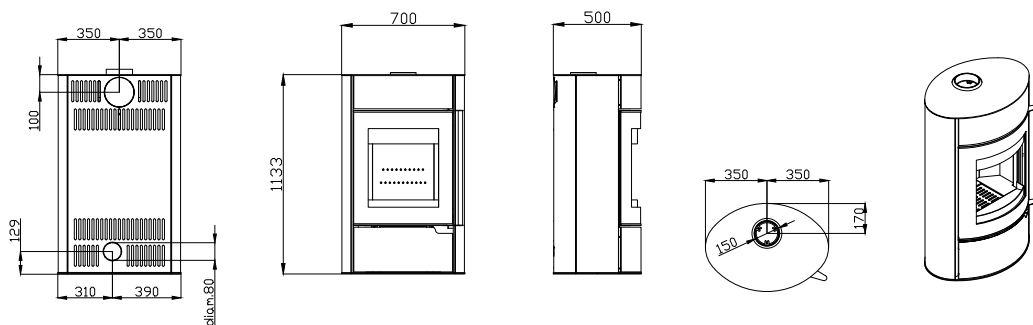

- A Rauchabzug ø 80 mm
- B Öffnungen für die Verbrennungsluft ø 40 mm
- C Hauptschalter
- D Manueller Thermostat zurücksetzen

ZERTIFIZIERUNGEN

EN 13240:2006

Swiss TRV Limits

German BIMSChv

Flamme Verte (7 stars)



Negro RAL 9005

DATOS TÉCNICOS

Potencia térmica nominal (max.)	10,3 kW
Rendimiento (max.)	85,3 %
Temperatura de los humos (max.)	241 °C
Longitud máxima de troncos de madera	500 mm
Consumo horario (max.)	2,75 kg/h
Volumen de calentamiento	295 m³
Emisiones CO (13% O₂) (max.)	1069 mg/m³
Masa de humos (max.)	7 g/s
Peso	125 kg
Dimensiones LxPxH	700x500x1133 mm
Dimensiones salida humos	ø 150 mm
Salida humos	Salida posterior, superior

EQUIPAMIENTO



Control de flujo de aire primario, secundario, terciario (vidrio)



Contenedor de cenizas extraíble



Cámara de combustión con aislamiento de vermiculita

DIMENSIONES

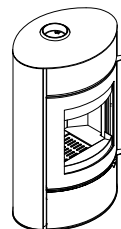
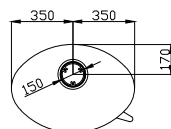
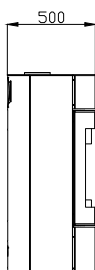
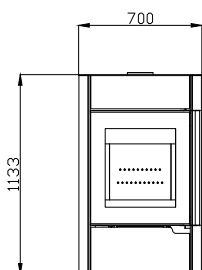
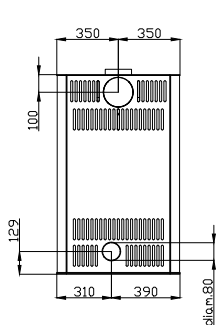

- A Salida de humos ø 80 mm
- B Aspiración de aire ø 40 mm
- C Interruptor
- D Termostato a rearme manual

CERTIFICACIONES

EN 13240:2006

Swiss TRV Limits

German BIMSChv

Flamme Verte (7 stars)



Czarny **RAL 9005**

DANE TECHNICZNE

Moc grzewcza całkowita (max.)	10,3 kW
Sprawność (max.)	85,3 %
Średnia temperatura spalin (max.)	241 °C
Maksymalna długość kłód drewna	500 mm
Zużycie paliwa moc (max.)	2,75 kg/h
Objętość ogrzewalna (indicativo)	295 m³
Emisja CO (13% O ₂) (max.)	1069 mg/m³
Masowy przepływ oparów (max.)	7 g/s
Waga	125 kg
Wymiary LxPxH	700x500x1133 mm
Ujście dymu	ø 150 mm
Ujście dymu	Wylot spalin górny, tylny

EQUIPAMIENTO



Pierwotna, wtórna, trzeciorzędowa (szklana) kontrola przepływu powietrza



Wyjmowany pojemnik na popiół



Komora spalania z izolacją wermikulitową

WYMIARY

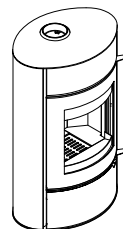
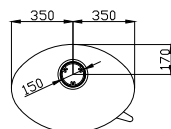
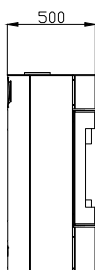
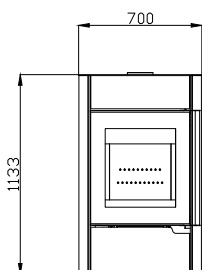
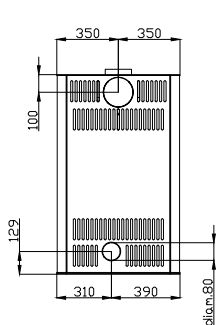

- A Ujście dymu ø 80 mm
- B Chwyt powietrza do spalania ø 40 mm
- C Wyłącznikiem
- D Termostat z ręcznym resetem

CERTYFIKATY

EN 13240:2006

Swiss TRV Limits

German BIMSChv

Flamme Verte (7 stars)